

Town and Country Planning Act 1990
The Council of the Borough of North Tyneside (11 East Farm Mews,
Backworth) Tree Preservation Order 2020

The Council of the Borough of North Tyneside in exercise of the powers conferred on them by sections 198 of the Town and Country Planning Act 1990 hereby make the following Order—

Citation

1. This Order may be cited as the 11 East Farm Mews, Backworth Tree Preservation Order 2020.

Interpretation

2. (1) In this Order “the authority” means the Council of the Borough of North Tyneside

(2) In this Order any reference to a numbered section is a reference to the section so numbered in the Town and Country Planning Act 1990 and any reference to a numbered regulation is a reference to the regulation so numbered in the Town and Country Planning (Tree Preservation)(England) Regulations 2012.

Effect

3.—(1) Subject to article 4, this Order takes effect provisionally on the date on which it is made.

(2) Without prejudice to subsection (7) of section 198 (power to make tree preservation orders) or subsection (1) of section 200 (tree preservation orders: Forestry Commissioners) and, subject to the exceptions in regulation 14, no person shall—

(a) cut down, top, lop, uproot, wilfully damage, or wilfully destroy; or

(b) cause or permit the cutting down, topping, lopping, wilful damage or wilful destruction of,

any tree specified in the Schedule to this Order except with the written consent of the authority in accordance with regulations 16 and 17, or of the Secretary of State in accordance with regulation 23, and, where such consent is given subject to conditions, in accordance with those conditions.

Application to trees to be planted pursuant to a condition

4.—In relation to any tree identified in the first column of the Schedule by the letter “C”, being a tree to be planted pursuant to a condition imposed under paragraph (a) of section 197 (planning permission to include appropriate provision for preservation and planting of trees), this Order takes effect as from the time when the tree is planted.

Dated this 3rd day of April 2020

The Common Seal of the
Council of the Borough of North Tyneside
was affixed to this order in the presence of:



Authorised Signatory



TREE PRESERVATION ORDER 2020
11, EAST FARM MEWS, BACKWORTH

SCHEDULE

The map referred to is at a scale of 1:500 and is based on an enlargement of the O.S. edition of sheet numbered NZ3072. The area covered by the Order is on land at 11, East Farm Mews, Backworth. The area is wholly within the Metropolitan Borough of North Tyneside in the County of Tyne and Wear.

SPECIFICATION OF TREES

TREES SPECIFIED INDIVIDUALLY (encircled in black on the map)		
<i>Reference on map</i>	<i>Description</i>	<i>Situation</i>
T1	Sycamore (Acer sp)	Located approximately 7.6m in a northerly direction from the north west corner of 11 East Farm Mews and approximately 9.5m in a north westerly direction from the north east corner of 11 East Farm Mews

TREES SPECIFIED BY REFERENCE TO AN AREA (within a dotted black line on the map)		
<i>Reference on map</i>	<i>Description</i>	<i>Situation</i>
None		

GROUPS OF TREES (within a broken black line on the map)		
<i>Reference on map</i>	<i>Description</i>	<i>Situation</i>
None		

WOODLANDS (within a continuous black line on the map)		
<i>Reference on map</i>	<i>Description</i>	<i>Situation</i>
None		

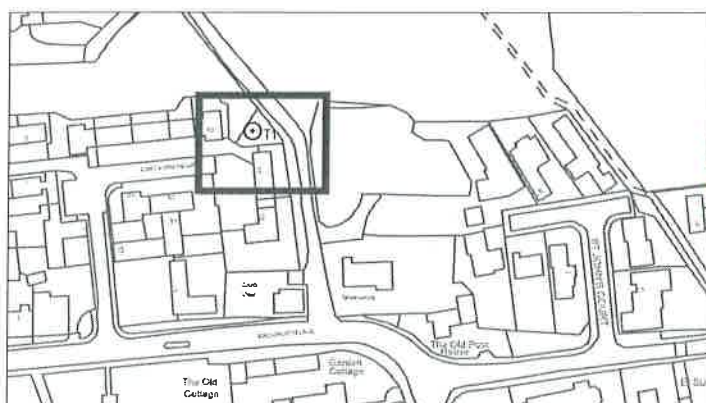
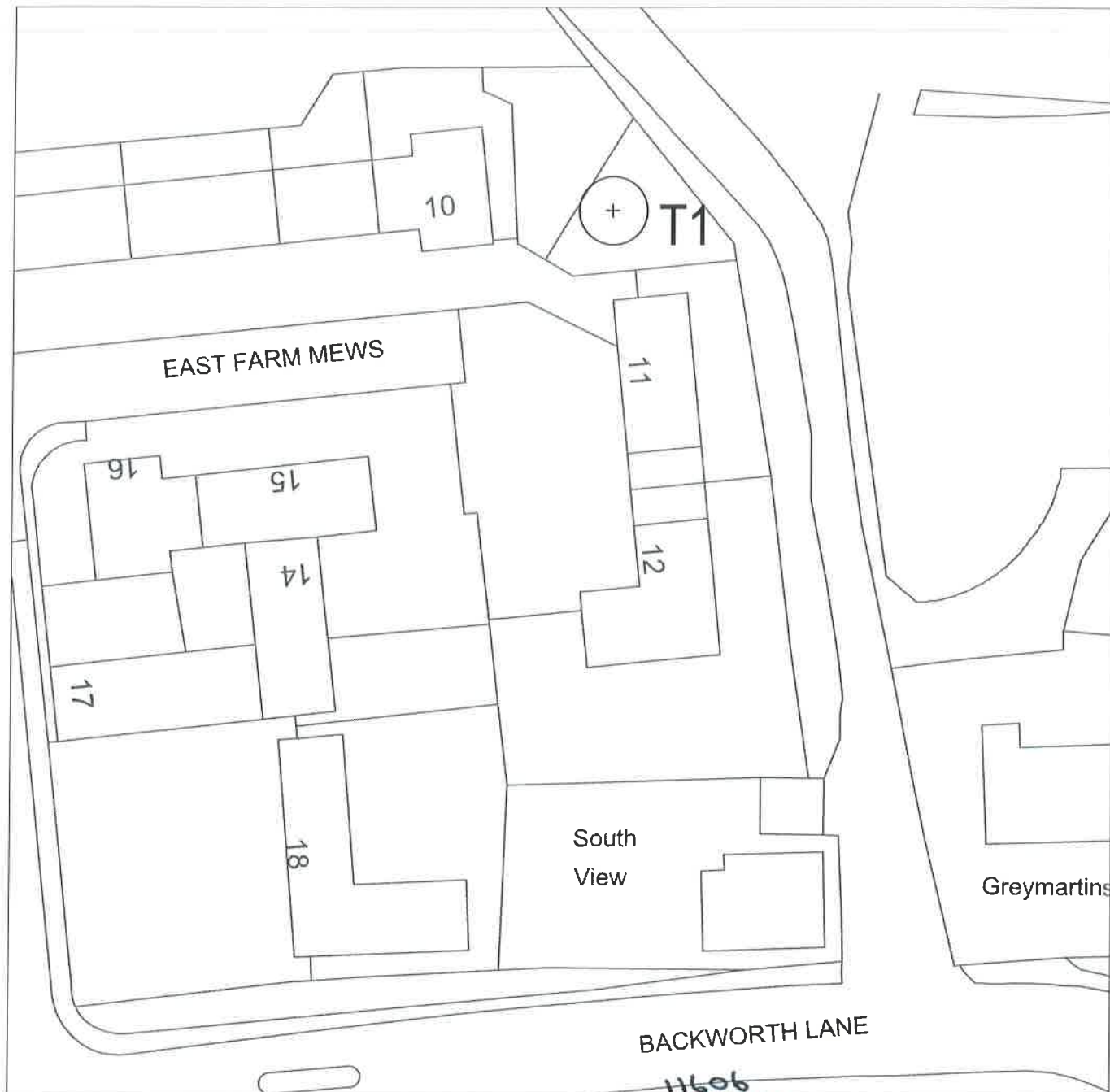

Phil Scott
 Head of Environment, Housing and Leisure
 Quadrant East
 The Silverlink
 Cobalt Business Park
 North Tyneside
 NE27 0BY

© Crown Copyright and database right 2020.
 Ordnance Survey Licence Number 0100016801

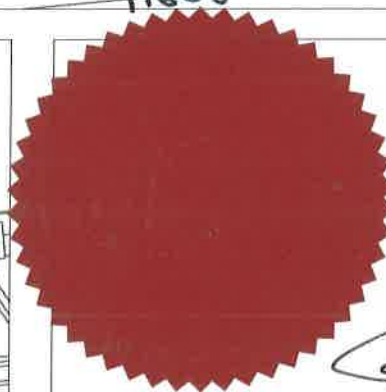

Dated this day :

3rd April 2020

The Common Seal of the Council of the
 Borough of North Tyneside was affixed to
 this Order in the presence of :

Authorised Signatory

**NORTH TYNESIDE COUNCIL
 TREE PRESERVATION ORDER 2020**

11, EAST FARM MEWS, BACKWORTH